

 **First in Quality. Built to Last.**



* ET 1608 shown

SHRINK TUNNELS

PERFORMANCE SERIES

RELIABLE SHRINK PERFORMANCE

EASTEY Performance Series Shrink Tunnels offer the reliability needed to provide positive shrinking of a wide range of films at a cost-effective price.

MODELS

ET1608-30, ET1610-36, ET1610-48, ET2010-36

BUILT RIGHT...PRICED RIGHT

Proven reliable over and over again, these intermediate level EASTEY Shrink Tunnels provide you with all the quality features found in much higher priced machines. They are designed and built to give you all the performance features needed for positive shrinking a wide variety of films including polyolefin, polyethylene, and PVC.

RUGGED DESIGN

EASTEY Performance Series Shrink Tunnels are expertly welded on 12 gauge steel frames and designed to produce superior shrinking on a virtually any package. Variable four-direction air flow, variable air velocity and delayed cool down are just some of the features that provide the durability you have come to rely on from EASTEY. See for yourself why EASTEY has been a leader in the shrink packaging industry for over 25 years.

STANDARD FEATURES

- Designed to seal most polyolefin, polyethylene, and PVC shrink film
- All-welded main frame from 12 gauge steel
- Live roller or stainless steel mesh belt conveyors; optional "dead" roller conveyor for polyethylene
- Sealed bearings (not bushings) on drive and idler shafts
- Adjustable digital solid state temperature control for a variety of film
- Four-directional air flow provides positive shrinking
- Variable air flow and air velocity for a variety of products and applications
- Bottom air flow adjustment – full on, 1/2 on, full off on ET2010
- Large ducting creates more air volume inside tunnel
- Optional side plates (top and sides) for air flow patterning and quick changeover for different products on ET2010
- Plugs available for patterned air flow
- Delayed cool down and over temperature protection
- Fold down electrical control panel for easy maintenance
- Conveyor speed up to 67 feet per minute
- Heavy duty casters for transportation within plant
- Leveling legs provide sturdy base once in place
- Custom two part epoxy finish resists scratching
- Available in 220v – single or 3-phase
- Easy to use design requires minimal training, maintenance, and trouble free operation
- Made in the USA



* ET2010 shown

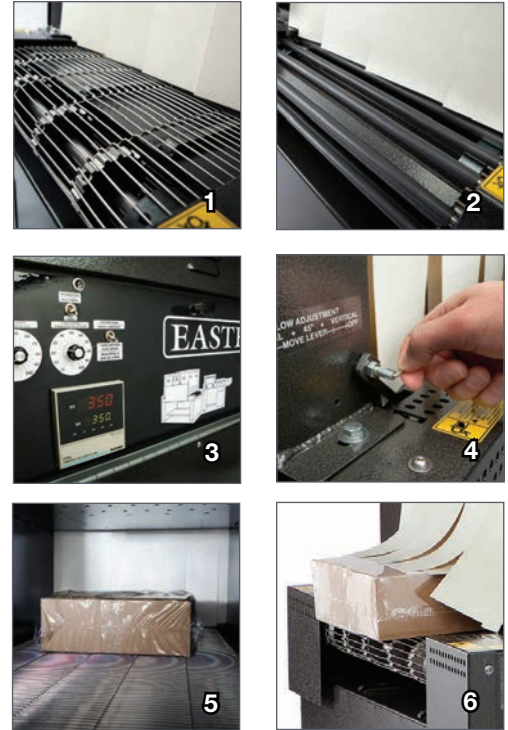

1. **Mesh belt**
Stainless steel mesh belt conveyor provides maintenance free operation
2. **Live Roller**
Live roller conveyor provides a more finished look for retail packaging applications
3. **Control panel**
Easy to use control panel lets users adjust for their specific application
4. **Air flow knob**
Variable air flow adjustments at your fingertips
5. **Inside of tunnel**
Four directional air flow provides positive shrinking
6. **Shrunk box coming out of tunnel**
Positive shrinking on most polyolefin, polyethylene and PVC film

MODEL NUMBER	MACHINE DIMENSIONS			CHAMBER DIMENSIONS			CONVEYOR WIDTH	CONVEYOR LENGTH	STANDARD POWER			WEIGHT	SHP WT.
	WIDTH (A)	HEIGHT (B)	LENGTH (C)	WIDTH	HEIGHT	LENGTH			VOLTS	AMPS	PHASE		
ET1608-30	29"	49"	40"	16"	8"	30"	16"	40"	220	40/25	1/3	650 lbs 294 kg	750 lbs 340 kg
ET1610-36	28"	64"	49"	16"	10"	36"	16"	48"	220	40/25	1/3	650 lbs 294 kg	750 lbs 294 kg
ET1610-48	28"	64"	61"	16"	10"	48"	16"	60"	220	40/25	1/3	750 lbs 294 kg	850 lbs 386 kg
ET2010-36	38"	51"	49"	20"	10"	36"	20"	49"	220	40/25	1/3	700 lbs 317 kg	800 lbs 364 kg



7041 Boone Avenue North, Brooklyn Park, MN 55428
 (763) 428-4846 1 (800) 835-9344
 www.eastey.com info@eastey.com

